

Jaku

Assembly Guide

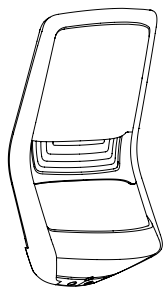

Components



Backrest



Seat



Gas Lift

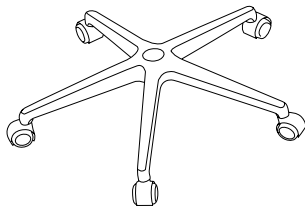

Base and Castors

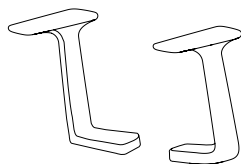

Fixed Armrests

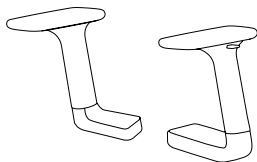

Adjustable Armrests

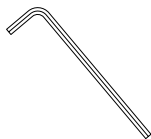

Allen Wrench



Bolts for Seat
and Backrest

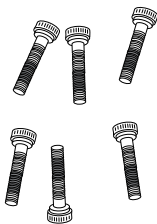

Bolts
for Armrest

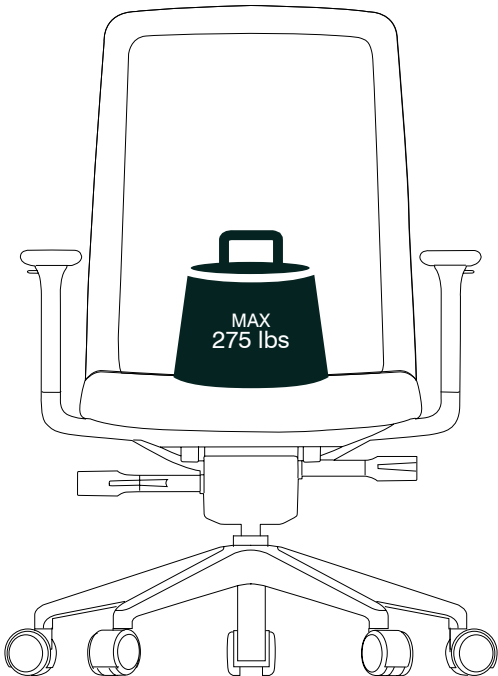

Installation

Step 1

Base and Gas Lift Assembly

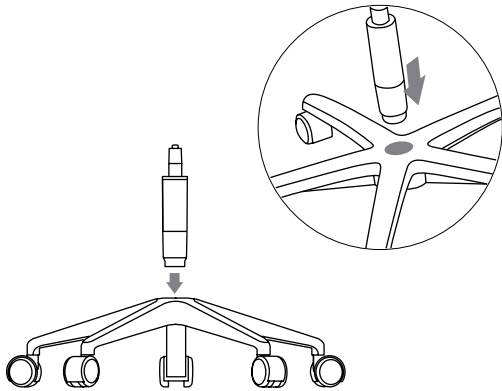

1. Assemble on a smooth surface to avoid scratching parts.
2. Turn the base upright and insert the gas lift.

Step 2

Seat and Armrest Assembly

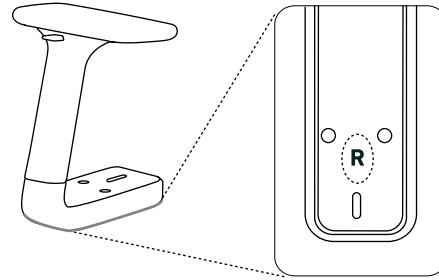

1. Check the L / R mark on the bottom of the armrests as shown.

Step 2.1

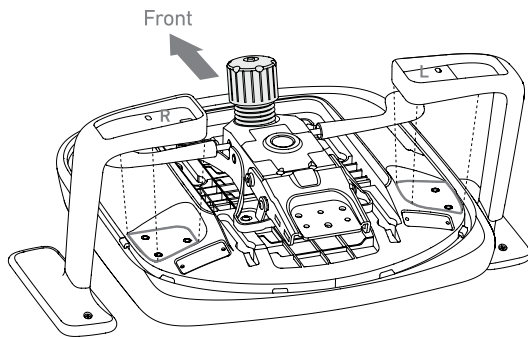

1. Referring to the image above, place the armrests.

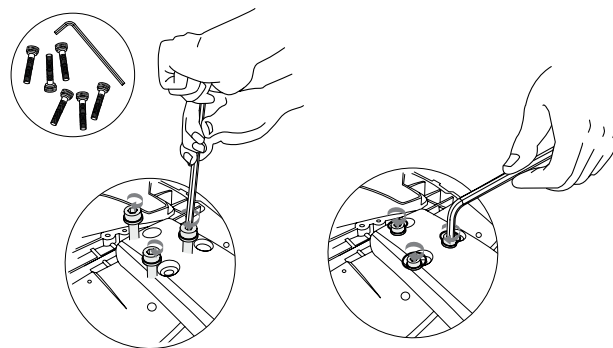

2. Insert the bolts and tighten lightly with allen wrench. Ensure bolts enter at a straight angle before tightening fully.

Installation

Step 3-A

Seat and Backrest Assembly – Smart Sync

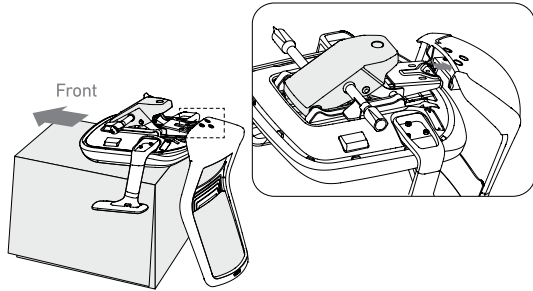

1. Insert the groove of the backrest assembly into the seat assembly

Step 3-B

Seat and Backrest Assembly – Step Sync

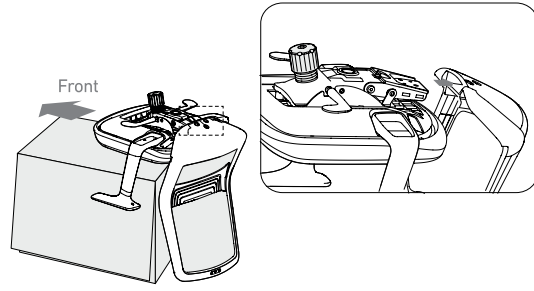

1. Insert the groove of the backrest assembly into the seat assembly

Step 3

Seat and Backrest Assembly

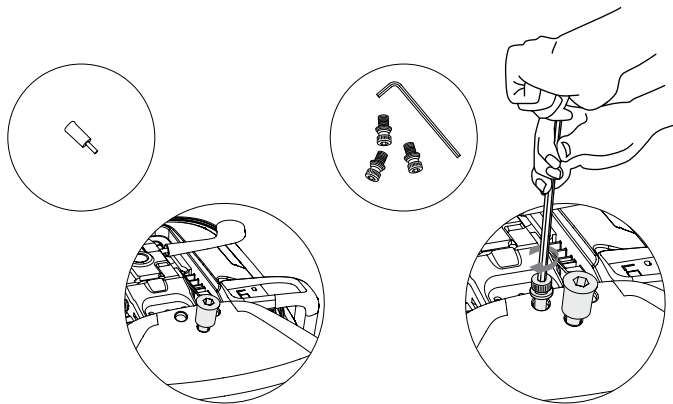

1. Align the connection groove between the seat assembly and the backrest assembly, and then insert the guide pin into the center hole.
2. Tighten seat assembly with the backrest assembly using the bolts (same way as assembling the armrests).
3. Remove the guide pin and assemble to the last bolt.

Installation

Step 4

Base Assembly

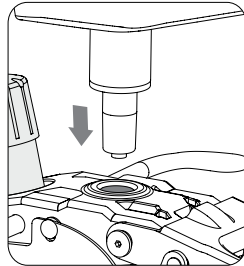
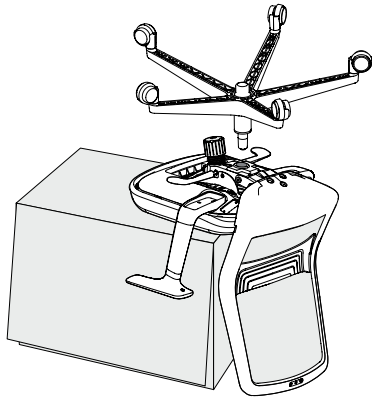

1. Combine the pre-assembled seat with the backrest.
2. Insert gas lift into the central hole of seat plate.
3. After the assembly, press the seat with weight to function height adjustment. Check the height adjustment lever works properly.

Step 4

Lumbar Support Assembly

1. Check the lumbar support assembly position of the backrest (assemble under the guideline of the backrest).
2. Insert the lumbar support assembly position. (The lumbar support assembly position is the groove located in the center of the backrest).
3. Same way as assembling the other side.
4. When removing the lumbar support, separate one by one after bending the lumbar support.

