iline

Power / Data Beam



A M Q

Statement of Line

Frame



90°/180° Post
(2-way, 3-way, 4-way)



120° Post
(3-way)

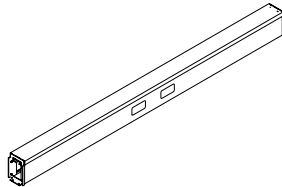

Beam



End Bracket Set

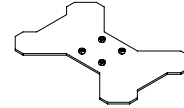

DR Center Foot

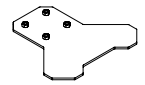

SR Center Foot

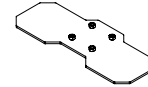

DR End Foot

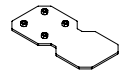

SR End Foot

Worksurfaces

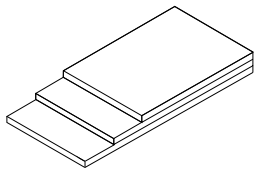

Linear
48", 60" and 72" widths

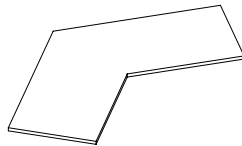

120°
with Activ-Pro3

Privacy Screens & Panels

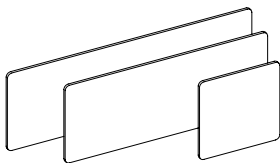

3F Screens

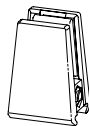

Screen Mounting Clips

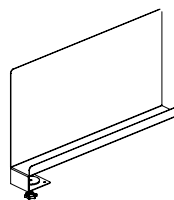

Side Screen

Accessories

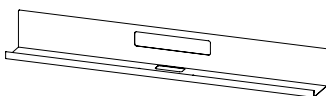

ILINE Wire Tray

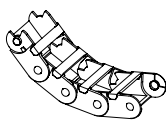

Cable Management Track

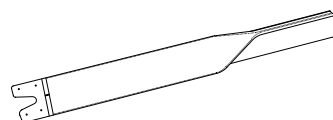

Soft Cable Management

Finishes

Frames

F1
Platinum

F2
White



Electrical

Iline beam technology distributes electrical with either 3 circuit/5 wire or 4 circuit/8 wire.

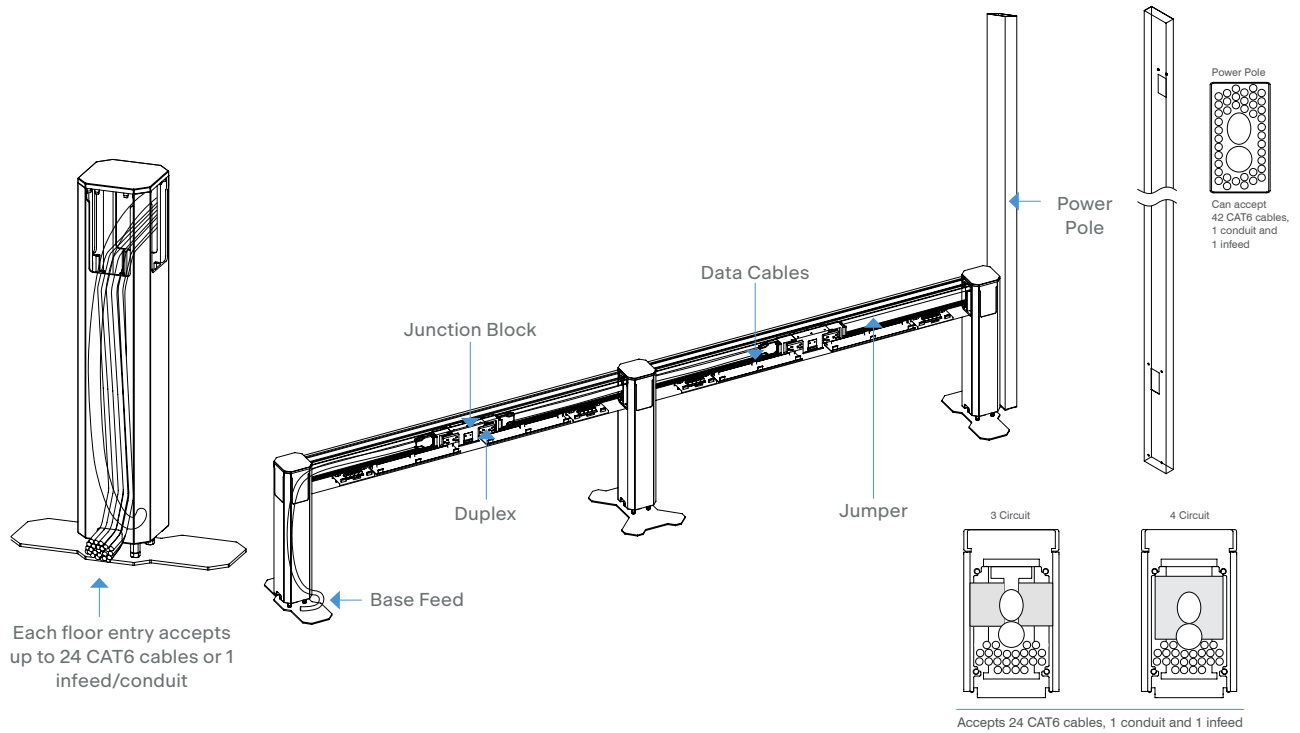

Jumpers – 3 Circuit/5 Wire

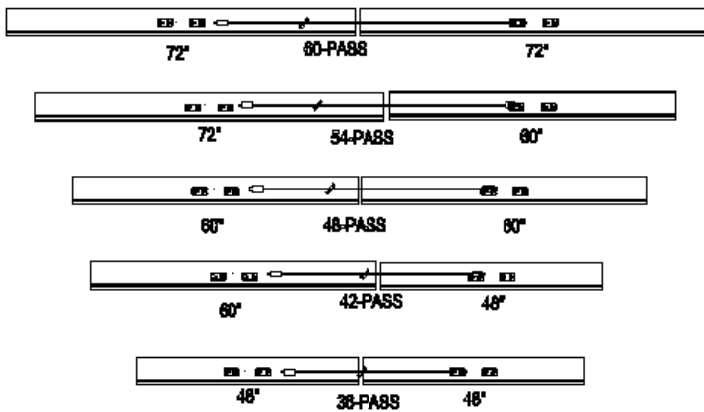

Jumpers – 4 Circuit/8 Wire

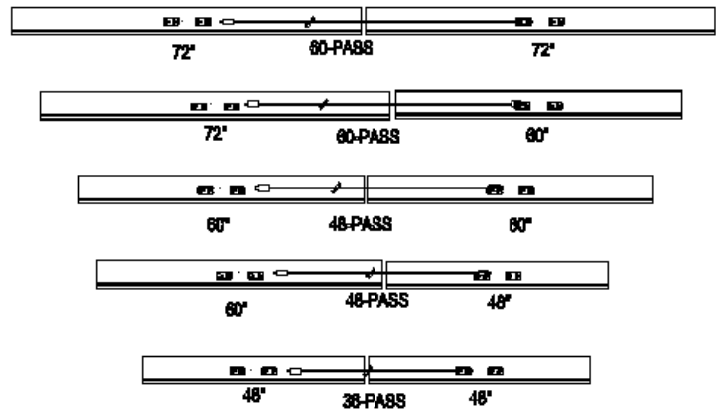

Electrical

4 Circuit/8 Wire

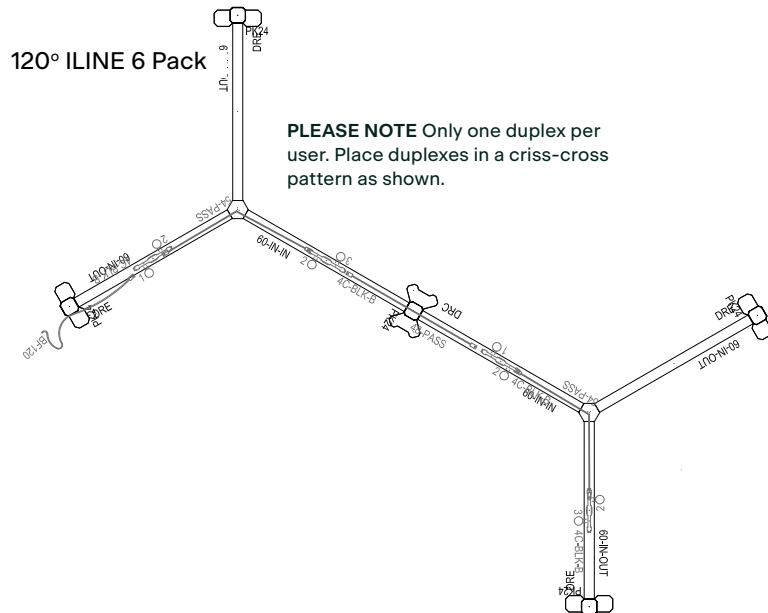

90° ILINE 4 Pack

Line 2 duplex receptacles used in each station to be compliant with California Title 24.

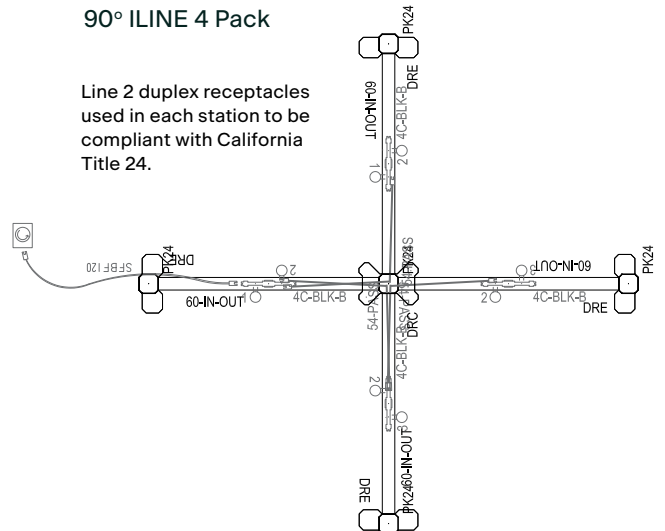

ILINE 8 Pack

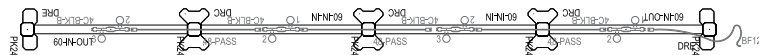

3 Circuit/5 Wire

90° ILINE 4 Pack

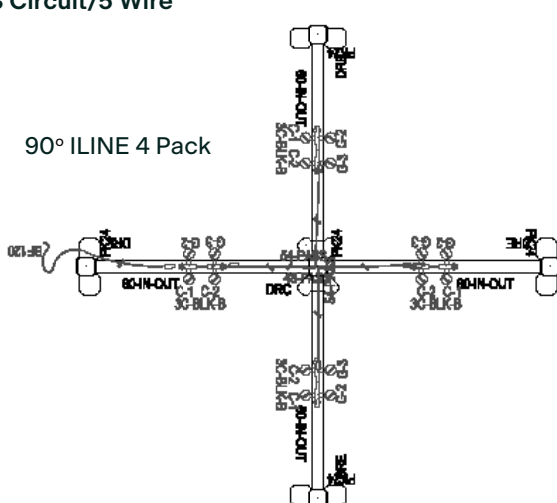

120° ILINE 6 Pack

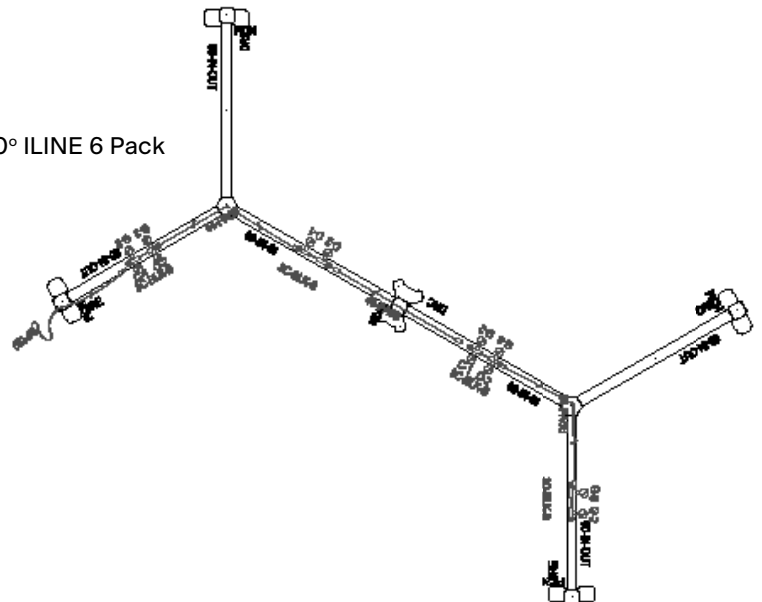

ILINE 8 Pack



Features



Linear, 90°, 120° and 180° configurations

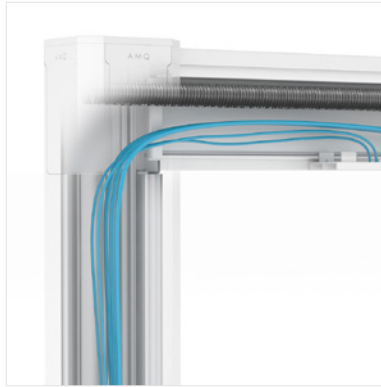

Power entry through side and center legs and power poles (3 or 4 circuit, 24 CAT cables)



Face Plates and Post Sleeves



Cable Management Tracks and Wire Trays



Up-mounted Privacy Screens

Installation Time

15 minutes

Warranty

10 years, parts only.

Care & Maintenance Instructions

Wipe with a damp cloth using water or gentle, nonabrasive cleaner. For guaranteed safety, patch test with diluted cleaner before wiping entire surface. Wipe dry with a clean cloth.

Certifications

ANSI/BIFMA X5.5-2014
Indoor Advantage Gold™